

- **DESCRIPTION.**

It is specially designed and developed for Euronix courts, allowing its assembly and its disassemble in different places without the necessity of anchor them to the ground.

The court hardly changes, this system is simply added to make a closed ring around it to ensure the stability of the set.

- **Buttress.**

Situated below the posts and corners, and they will be counterweighed in turn, with different sizes mass concrete blocks (really, they are filled metallic profiles). They are placed before the structure since they will be the base because of their rods for the anchor plates; on the other hand, the buttress arm will grab the post or corner.

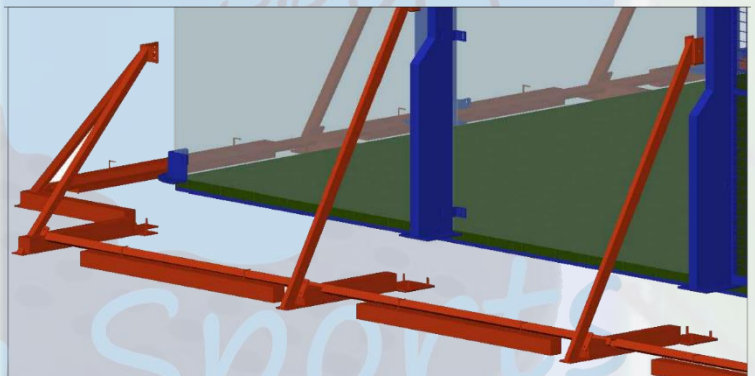

In order to constantly improve the quality of our products, Euronix reserves the right to modify any of the technical characteristics.

- **Stiffeners.**

They can be distinguished four types, three will always exist whereas the other only when the court is the 3x2 version.

-Ring and Access stiffeners: Will always exist.

The stiffeners of the ring joins the buttress, and will be also counterweighted with mass concrete blocks because of they have kind of hooks.

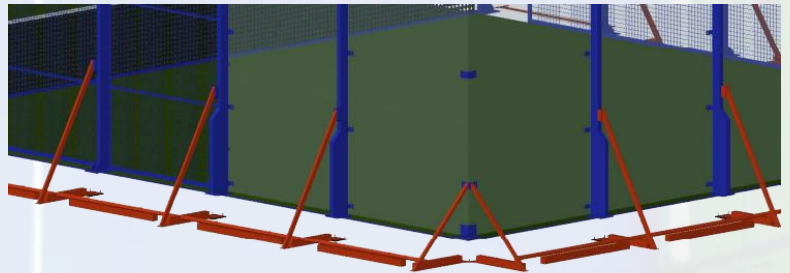

At the door, there will not be this type of stiffeners due to obvious access issues, so there are disposed two kinds of door stiffeners, some on the ground and others at the mesh.

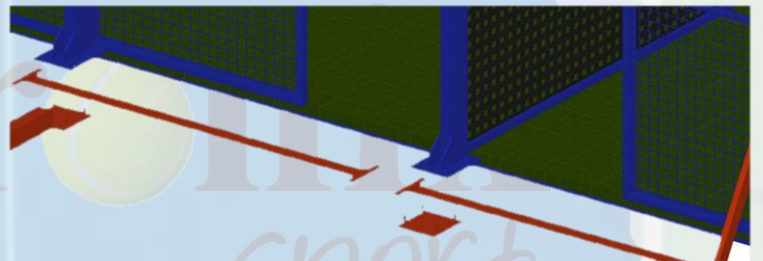
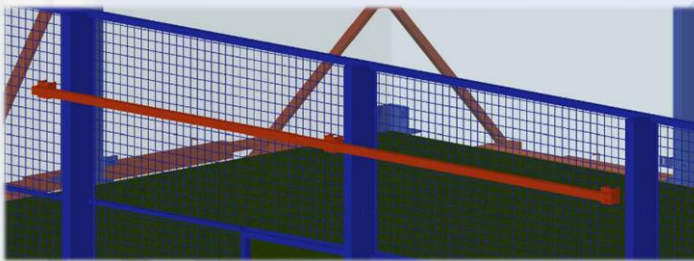

-3x2 Stiffeners: They are added on top of the glass 3x2 on the side (which was previously 2x2 with mesh)

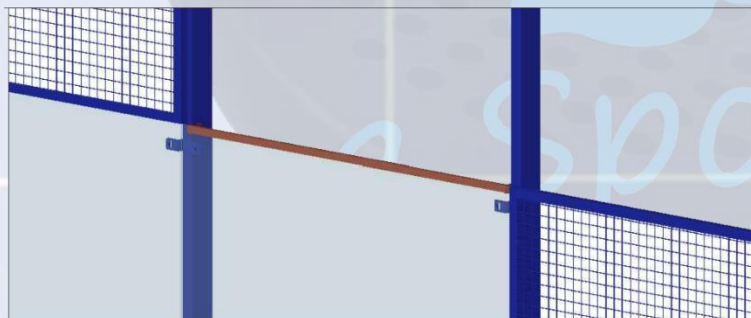

In order to constantly improve the quality of our products, Euronix reserves the right to modify any of the technical characteristics.