

Data sheet index

- EUROGROUND BASKET BASKET HOOP.2
 - Structure.3
 - Frame stabilization system and basket frame.3
 - Anchorage.....4
 - Materials.5

CERTIFICADORA
ACREDITADA POR **ENAC**

In order to constantly improve the quality of our products, Euronix reserves the right to modify any of the technical characteristics.

- **EUROGROUND BASKET BASKET HOOP.**

The monotube **BASKET EUROGROUND** basket hoop which has a 1,65 meters cantilever, are made according to the **UNE EN 1270:2006 GUIDELINE**.

They are inside **Type 7: Fixed to the ground;** and are designed to be able to install in whatever exterior surface.

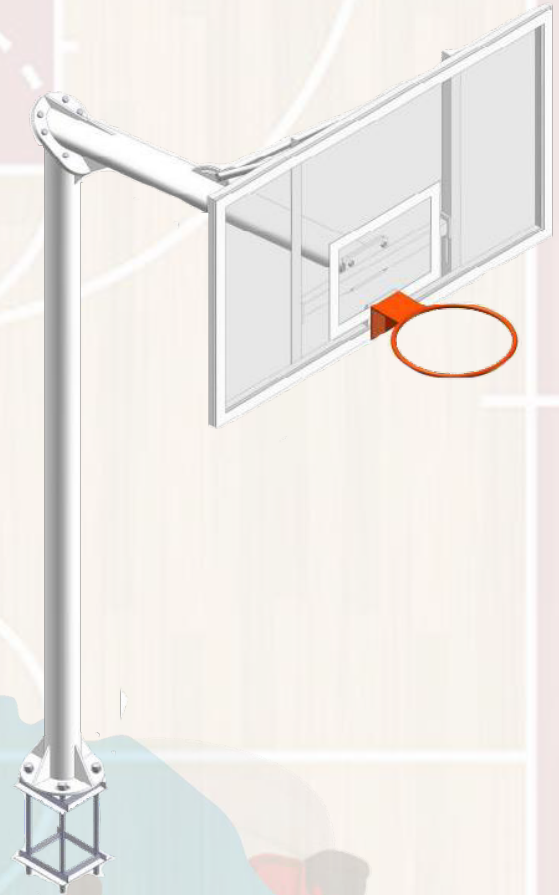

They are made fundamentally of:

- Structure (tubular).
- The frame stabilization system.
- Frame (and accesories)
- Anchorage.

In order to constantly improve the quality of our products, Euronix reserves the right to modify any of the technical characteristics.

- **Structure.**

It's made of two large diameter tubular profiles joined at an angle by a very resistant double plate with 3 reinforcement plates to ensure the stability of the structure

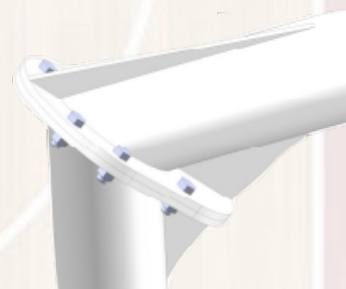

- **Frame stabilization system and basket frame.**

The basket frame is fully established by two stiffeners made of a pair of tubes that joins the structure with the frame, guaranteeing 100% the straightness of the board, obtaining the desired perpendicularity with respect to the ground.



In addition, **the basket frame is 1800mmx1050mm according to the guideline** and it is joined to the basket arm through a robust profile.

The panel can be of methacrylate, fibre or metallic.

The frame has two angles welded at the back ensuring the resistance of the equipment, and at the front the rim and the net fully normalized.

In order to constantly improve the quality of our products, Euronix reserves the right to modify any of the technical characteristics.

- **Anchorage.**

The basket is fully fixed to the ground by a plate with 4 squares which is screwed to the anchorage that it is fixed in a concrete foundation under the ground.

In this way a robust block is achieved that ensures the rigidity and stability of the basket.

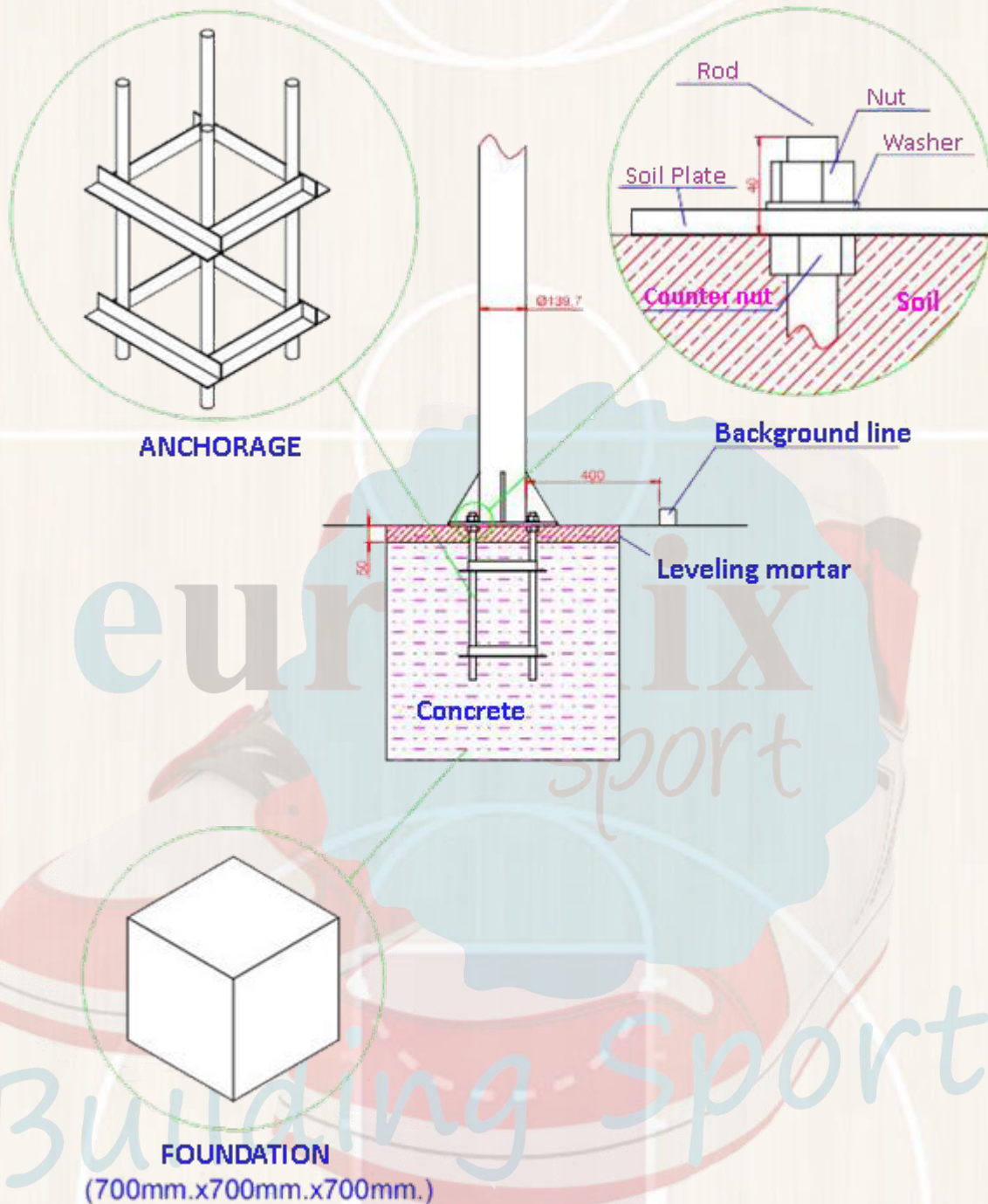

In order to constantly improve the quality of our products, Euronix reserves the right to modify any of the technical characteristics.

○ **Materials.**

Element	Specification
Profiles / Plates / Frame	S235 JR y S275 JR Steel
Screws	Zinc (Zn) Quality 8.8
Net	Natural or synthetic fiber.

Ref.	Finish	Dimensions (m)	Weight (Kg.)
EB008	Galvanized	1 bag of 3,27x0,40x0,40	73
		1 bag of 1,70x0,40x0,30	
		1 bag of 1,80x1,05x0,10	+/-60 Depending on the panel
EB009	100% Polyester painted	1 bag of 3,27x0,40x0,40	73
		1 bag of 1,70x0,40x0,30	
		1 bag of 1,80x1,05x0,10	+/-60 Depending on the panel

In order to constantly improve the quality of our products, Euronix reserves the right to modify any of the technical characteristics.